

FOR LEASE



5TH STREET FLEX SPACE

FLEX SPACE IN CENTRAL SIOUX FALLS

Bender
COMMERCIAL



**2228-2232 W 5TH STREET
SIOUX FALLS, SD**



**2228: 4,464 SF
2232: 2,220 SF**



**2228: \$7.50/SF
2232: \$7.00/SF
EST NNN: \$1.75/SF**

- Clean flex space located in central Sioux Falls.
- Suite 2228 (4,464 SF) has an office area with restrooms, mezzanine storage, two (2) 14'H overhead doors, double pit floordrain, and hanging Reznor forced air heater.
- Suite 2232 (2,220 SF) has a shop/warehouse area, two (2) 14' H overhead doors, double pit floordrain, and hanging Reznor forced air heater. Space is plumbed for restroom.
- Sprinklered.
- Zoned I-1 Light Industrial.
- Large parking lot.
- Monument signage available.
- Located near Kiwanis Avenue, providing easy access to 12th Street, Madison Street, and I-29.

AUSTIN LUECKE

austin@benderco.com
605-900-2407

BRADYN NEISES, SIOR

bradyn@benderco.com
605-579-0189



Bender Commercial Real Estate Services | 305 West 57th Street | Sioux Falls, SD 57108 | 605-336-7600 | benderco.com

© 2026 Bender Companies. Information herein deemed reliable, but not guaranteed.

5TH STREET FLEX SPACE



FLEX SPACE FOR LEASE

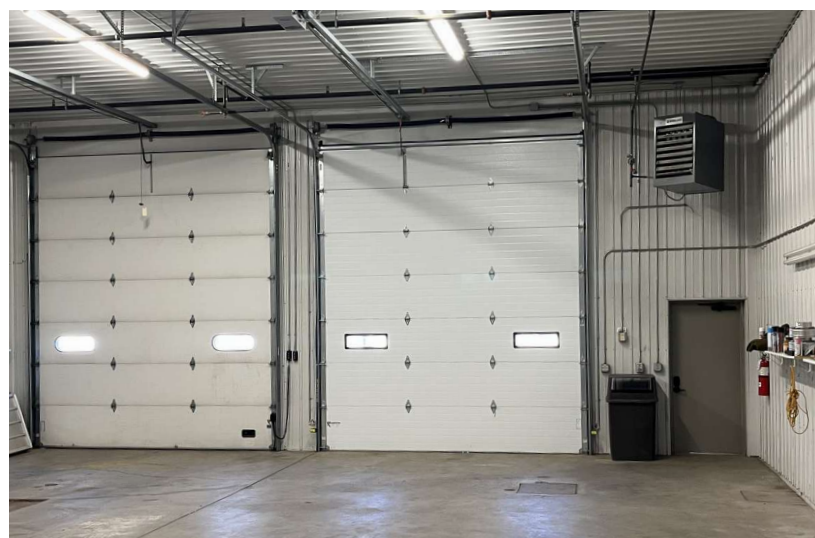
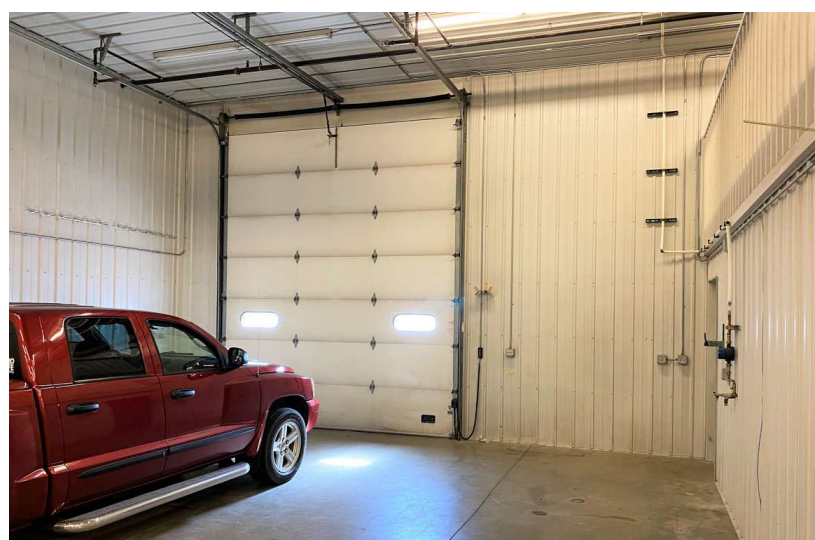

5TH STREET FLEX SPACE



FLEX SPACE FOR LEASE

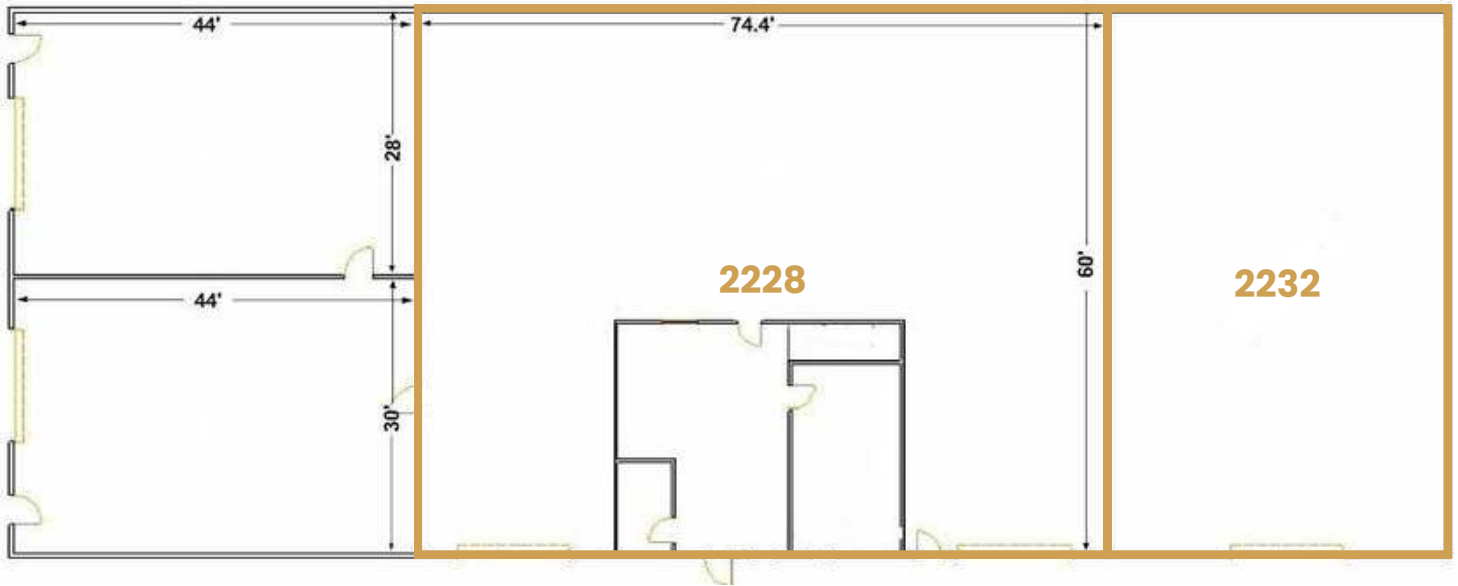

5TH STREET FLEX SPACE



FLEX SPACE FOR LEASE

