

FOR SALE



LAKE LORRAINE RESTAURANT

RESTAURANT WITH DOUBLE LANE DRIVE-THRU

Bender
COMMERCIAL



**2201 SOUTH LORRAINE PLACE
SIOUX FALLS, SD**



2,524 SF



\$1,950,000

- Restaurant with double-lane drive-thru in the Lake Lorraine shopping development near 26th Street and Marion Road in west Sioux Falls.
- Includes dining area with seating; a full commercial kitchen with hood, walk-in cooler, and walk-in freezer; and a two-lane drive-thru.
- 28 parking spaces.
- Built in 2023.
- Nearby businesses include Hyatt Place, The BLU on Lorraine, Avera Medical Group, Sioux Falls Ford, Lowe's, Hy-Vee, Hobby Lobby, DSW, Carsforsale.com, Anytime Fitness, and Dave & Buster's.
- Convenient access to 26th Street, Marion Road, and Interstate 29.
- Furniture, Fixtures, & Equipment (FF&E) not included in pricing but is negotiable.

ALEX SOUNDY, CCIM, SIOR | alex@benderco.com | 605-376-3700



Bender Commercial Real Estate Services | 305 West 57th Street, Sioux Falls, SD 57108 | 605-336-7600 | benderco.com

© 2026 Bender Companies. Information herein deemed reliable, but not guaranteed.

LAKE LORRAINE RESTAURANT



RESTAURANT WITH DOUBLE-LANE DRIVE-THRU FOR SALE

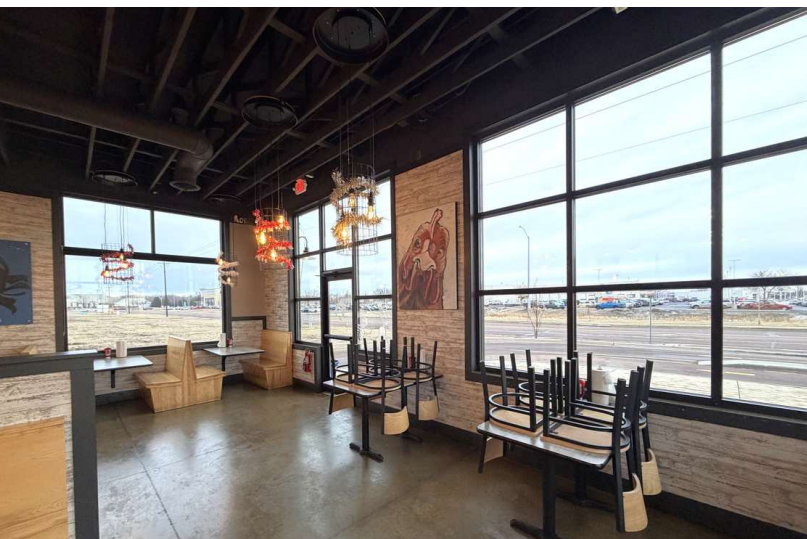

LAKE LORRAINE RESTAURANT



RESTAURANT WITH DOUBLE-LANE DRIVE-THRU FOR SALE



LAKE LORRAINE RESTAURANT



RESTAURANT WITH DOUBLE-LANE DRIVE-THRU FOR SALE

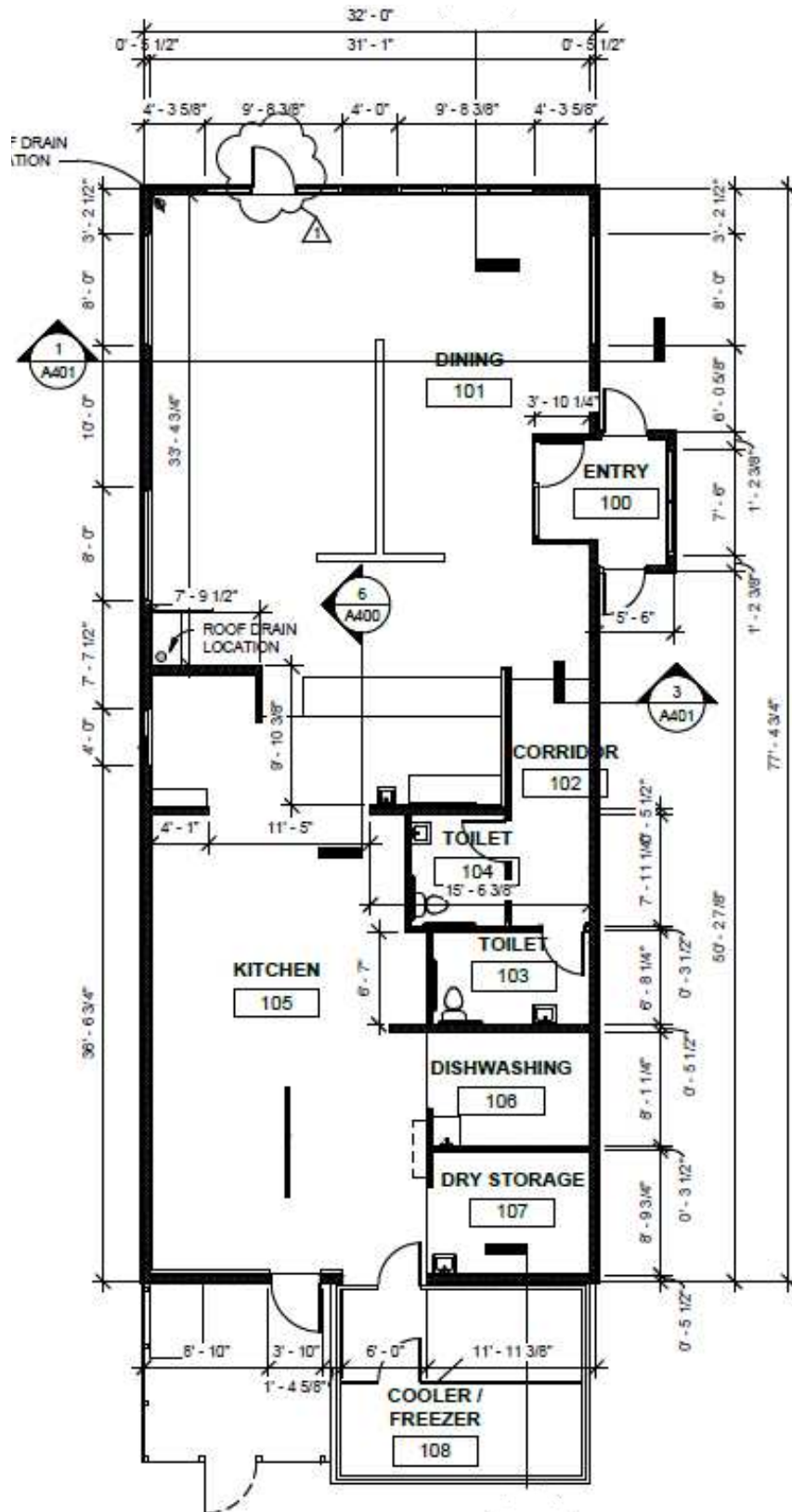

LAKE LORRAINE RESTAURANT



RESTAURANT WITH DOUBLE-LANE DRIVE-THRU FOR SALE



LAKE LORRAINE RESTAURANT



RESTAURANT WITH DOUBLE-LANE DRIVE-THRU FOR SALE



LAKE LORRAINE RESTAURANT



RESTAURANT WITH DOUBLE-LANE DRIVE-THRU FOR SALE

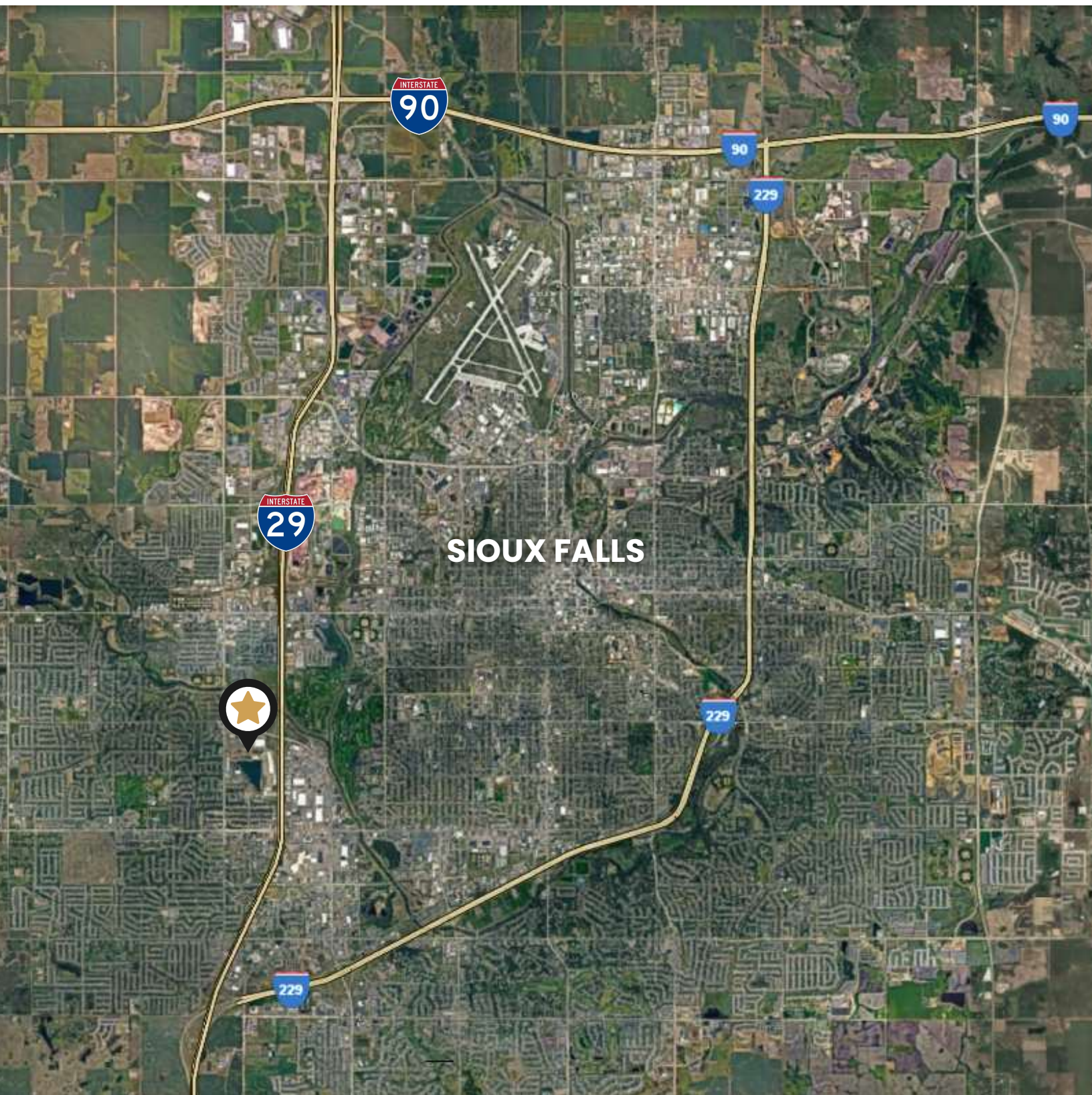

LAKE LORRAINE RESTAURANT



RESTAURANT WITH DOUBLE-LANE DRIVE-THRU FOR SALE

