

FOR LEASE



CENTURY BUSINESS PARK

WAREHOUSE SPACE

Bender
COMMERCIAL



**710 NORTH EBENEZER AVENUE
SIOUX FALLS, SD**



13,628 SF

\$ \$8.25/SF NNN

- Warehouse in the Legacy North Farm Development in west Sioux Falls.
- Space has four (4) 10'H x 9'W dock high doors.
- 21'6" clear height.
- 480/277v and 208/120v 3-Phase 200 amp power.
- Ample onsite parking.
- Easy access to I-29, Madison Street and West 12th Street.
- TI allowance negotiable.

BRADYN NEISES, SIOR

bradyn@benderco.com

605-782-1682

DOUGLAS BROCKHOUSE

dbrock@benderco.com

605-728-5800



Bender Commercial Real Estate Services | 305 West 57th Street | Sioux Falls, SD 57108 | 605-336-7600 | benderco.com

© 2025 Bender Companies. Information herein deemed reliable, but not guaranteed.

CENTURY BUSINESS PARK



WAREHOUSE SPACE FOR LEASE



CENTURY BUSINESS PARK



WAREHOUSE SPACE FOR LEASE

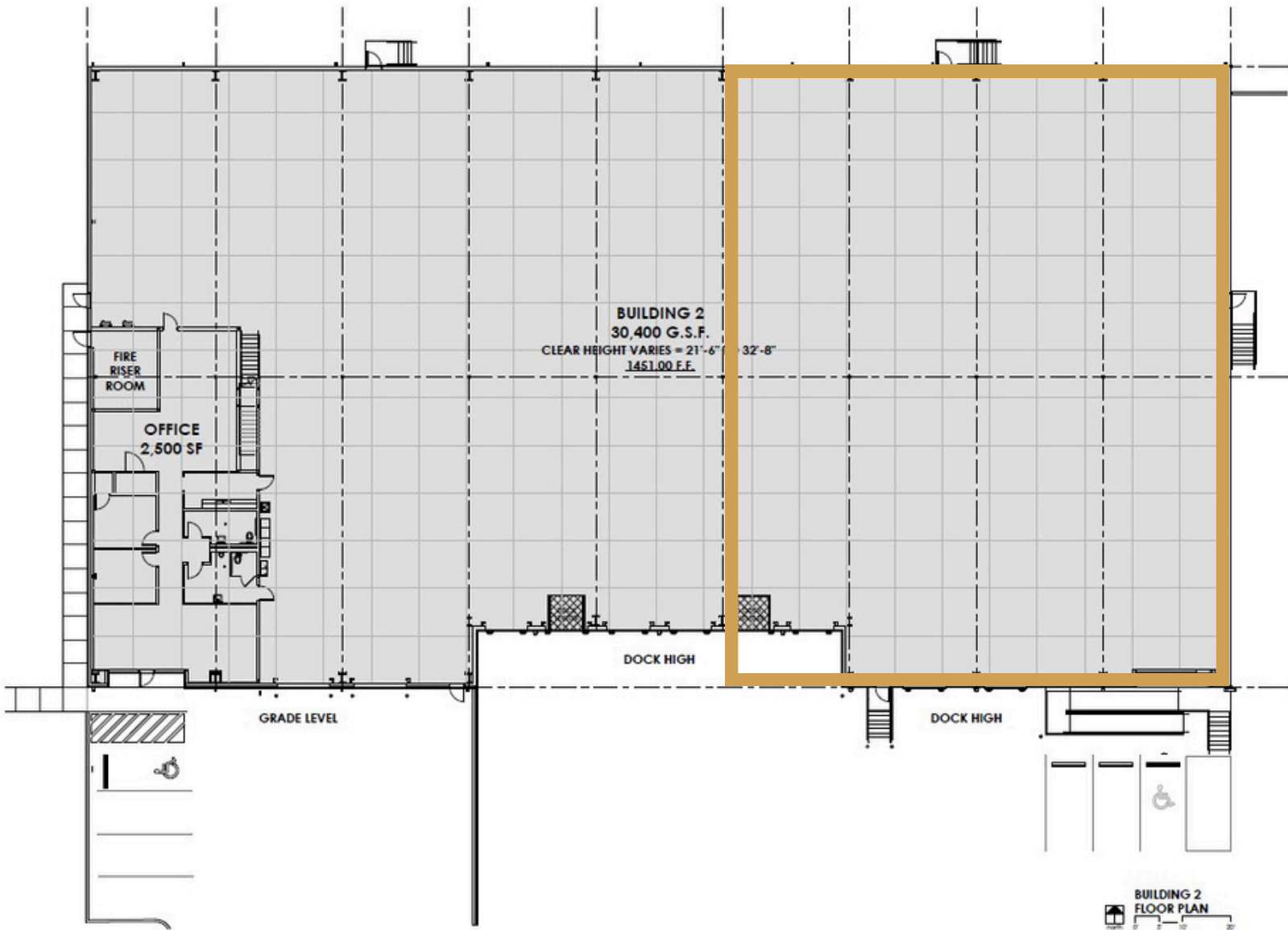

CENTURY BUSINESS PARK



CENTURY BUSINESS PARK



WAREHOUSE SPACE FOR LEASE



CENTURY BUSINESS PARK



WAREHOUSE SPACE FOR LEASE

