

FOR LEASE | OFFICE SPACE | 1741 SOUTH CLEVELAND AVENUE, SUITE 302 | SIOUX FALLS, SD

LEVO BUILDING SUITE 302

- **4,064 RSF (3,648 USF)**
- **For Lease: \$15.50/SF NNN**
Estimated NNNs: \$5.90/SF
- Upper level office space in premier office building in east Sioux Falls.
- Space has reception area, nine (9) private offices, large conference room and open work area.
- Common area restrooms.
- Ample on-site parking.
- Building signage.
- Great visibility along main eastside thoroughfare with a daily traffic count of 24,400 vehicles along East 26th Street.
- Easy access to I-229
- Can be subdivided – contact broker for details.

ALEX SOUNDY
alex@benderco.com
(605) 376-3700

MICHAEL BENDER, CCIM, SIOR
michael@benderco.com
(605) 782-1660

Bender Commercial Real Estate Services

305 West 57th Street
Sioux Falls, SD 57108
(605) 336-7600
www.benderco.com

Bender
COMMERCIAL

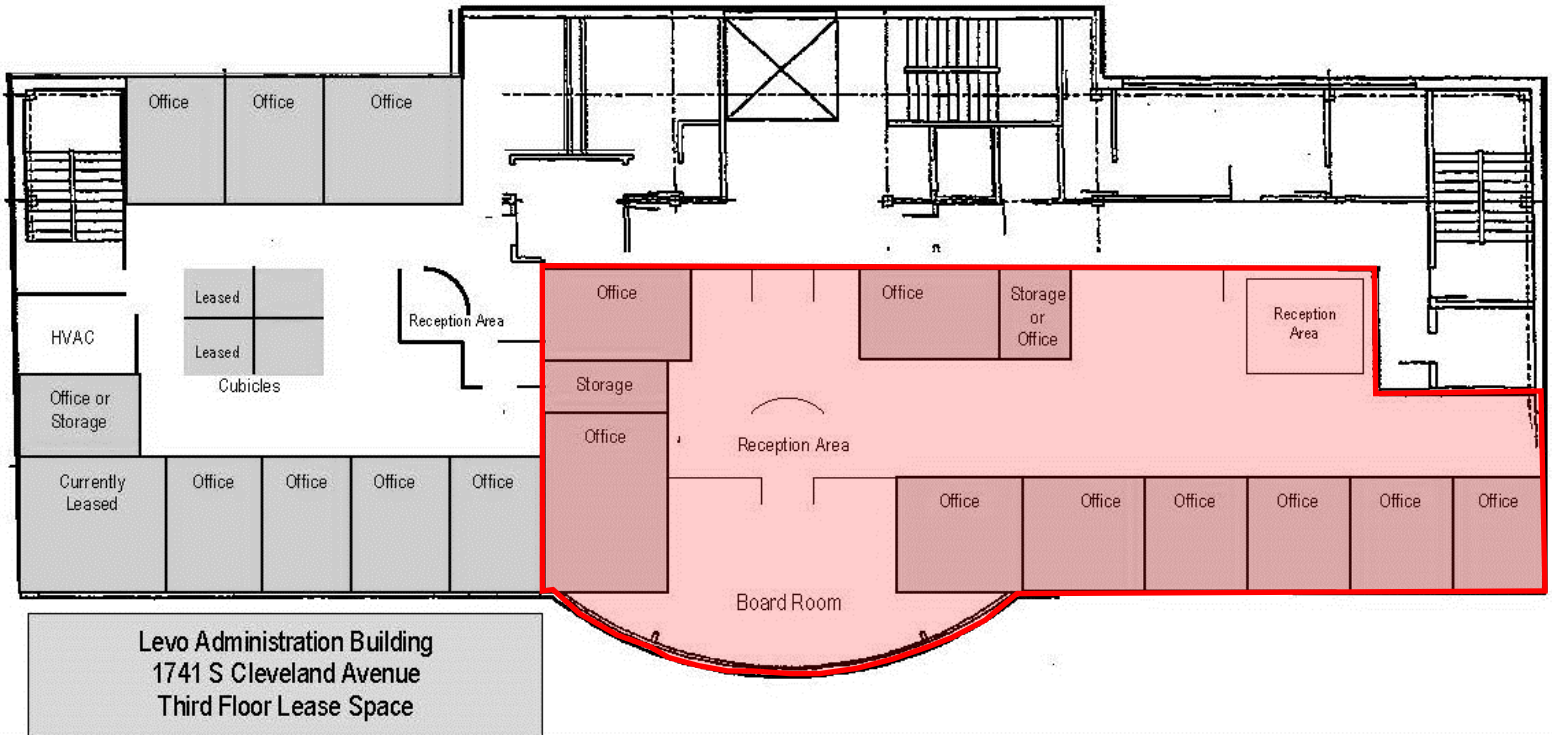



Bender Commercial Real Estate Services
305 West 57th Street
Sioux Falls, SD 57108
(605) 336-7600
www.benderco.com

Bender
COMMERCIAL



Bender Commercial Real Estate Services
305 West 57th Street
Sioux Falls, SD 57108
(605) 336-7600
www.benderco.com

Bender
COMMERCIAL

LEVO BUILDING | FOR LEASE | 1741 SOUTH CLEVELAND AVENUE | SIOUX FALLS, SD

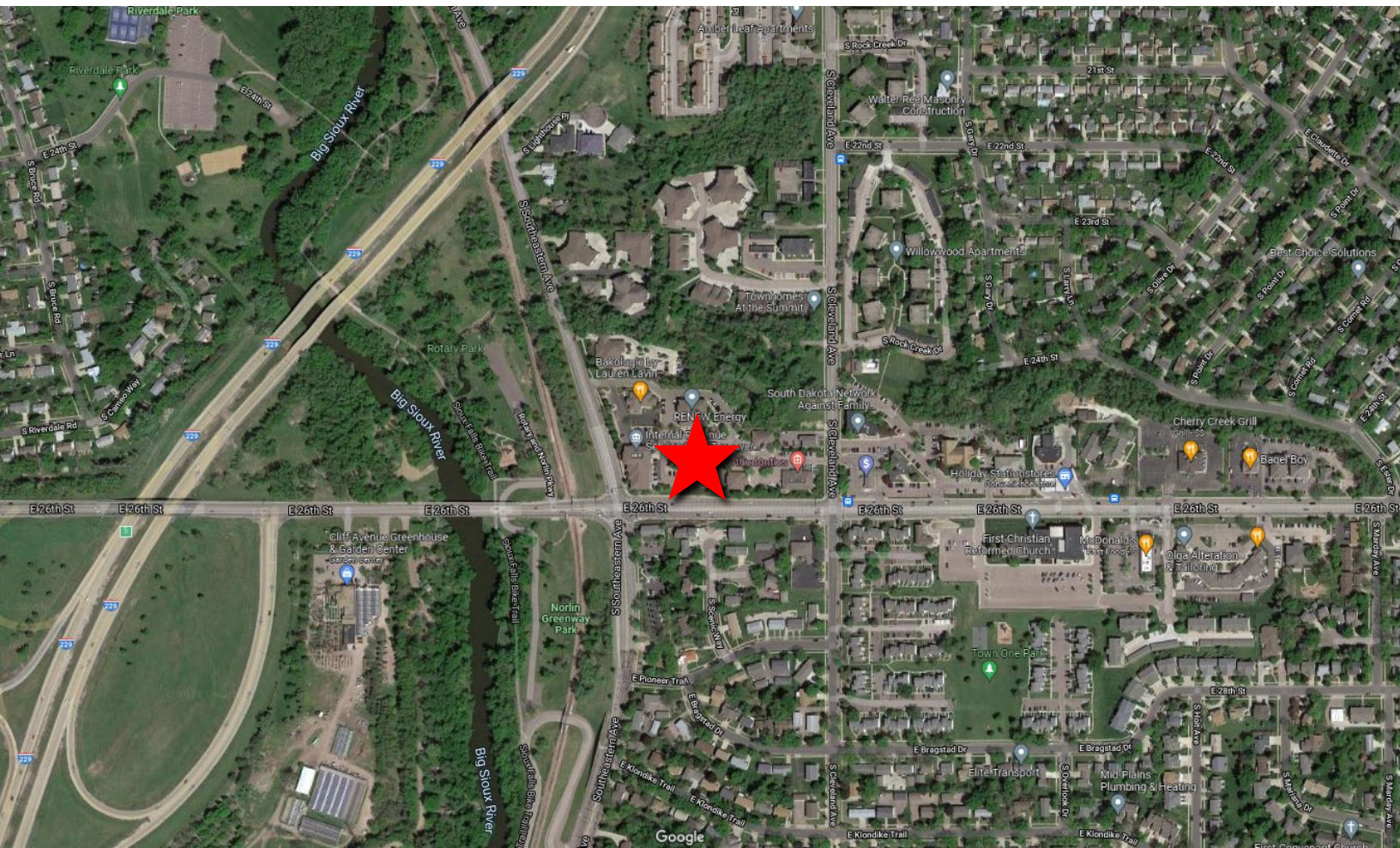

Bender Commercial Real Estate Services
305 West 57th Street
Sioux Falls, SD 57108
(605) 336-7600
www.benderco.com

Bender
COMMERCIAL